

Fasteners

Clips & Fasteners for ASHRAE Type Filters

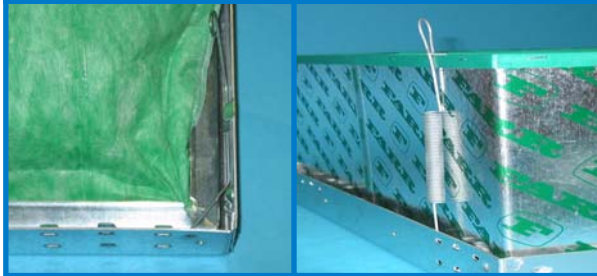

Fasteners to ensure that the system efficiency will be equivalent to the filter efficiency



C-70 fastener securing the header of a Camfil Farr Hi-Flo®, the same fastener may be applied to any 1" nominal size headered air filter.

C-80 fastener and rigid filter installed in a Camfil Farr Type 8 Holding Frame applying 25 pounds of filter sealing pressure per corner.

Fasteners are available for Camfil Farr holding frames and housings, or for other manufacturers air filter mounting systems. Our fasteners are designed to ensure that your system air quality is equivalent to the highest level of your system's filter efficiency. Each fastener contributes to an air tight seal between the mounting mechanism and the air filter (requires the appropriate sealing gasket on the filter or the filter mounting mechanism).

Constructed of high-tensile strength metals Camfil Farr fasteners are unchallenged by the repeated rigors of filter change and maintenance.

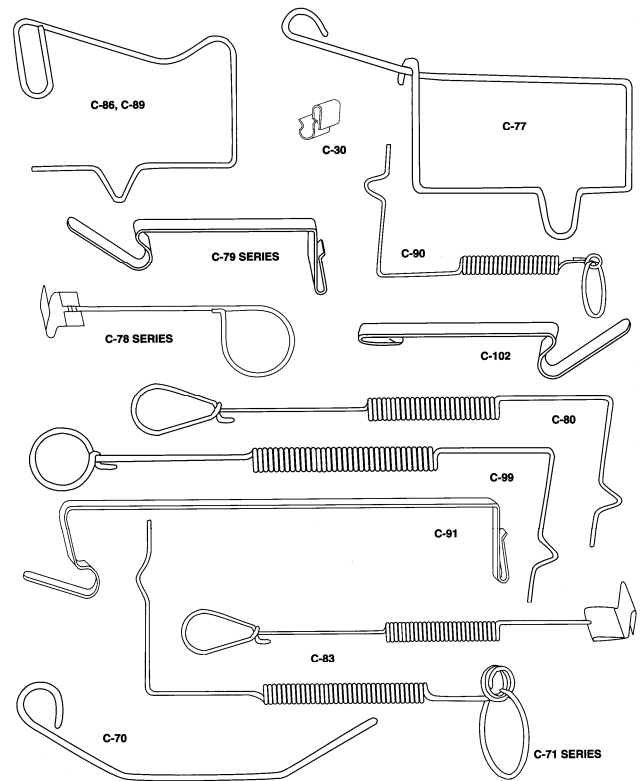

Just a few of the fasteners available.



Camfil Farr	Product sheet
Camfil Farr Fasteners	2902 - 0609
Camfil Farr—clean air solutions	

APPLICATIONS (4 fasteners required per filter for all applications) (See Sales Drawing # 050202)		ACCESS ⁶	MODEL NUMBER	PART NUMBER
30/30 [®] AEROPLEAT [®] OR OPTI-PAC [®] In Type 8 Holding Frame	1" or 2" deep filter	U or D	C-70	050025-000
	4" deep filter (use C-77 for Opti-Pac)	U	C-86	074437-000
		U or D	C-77 ¹	059615-001
	2" deep filter as a prefilter to a Riga-Flo, or Aeropac (no header)	U	C-79-1	061179-001
	4" deep filter as a prefilter to a Riga-Flo, or Aeropac (no header)		C-79-2	061179-002
	4" deep Opti-Pac with 2" deep prefilter		C-79-5	061179-005
	4" deep Opti-Pac with 4" deep prefilter		C-79-6	061179-006
	2" deep filter as a prefilter to a Riga-Flo E-Series (no header)		C-102-1	124298-001
	4" deep filter as a prefilter to a Riga-Flo E-Series (no header)		C-102-2	124298-002
	1" deep filter as a prefilter in the same frame with Hi-Flo, Riga-Flo PH-A or Aeropac (single header)		C-70 ⁴	050025-000
	2" deep filter as prefilter in the same frame with Hi-Flo, Riga-Flo PH-A or Aeropac (single header) (Two C-70 should be used to hold headered filter in place, and two C-86 fasteners (or C-77) should be used to hold prefilter in place. Fasteners would be on opposite corners).		C-86 ⁴ or C-77 ¹ & C-70	074437-000 059615-001 050025-000
	4" deep filter as a prefilter in the same frame with Hi-Flo, Riga-Flo PH-A or Aeropac (single header)		C-89 ⁴ & C-70	078865-000
	2" deep filter as a prefilter in the same frame with Aeropac (double header)		C-103-1	403229-001
4" deep filter as a prefilter in the same frame with Aeropac (double header)	C-103-2	403229-002		
30/30 [®] AEROPLEAT [®] Hi-Flo [®] Riga-Flo [®] Opti-Pac [®] In Competitive Holding Frame	1" deep filter	U or D	C-78-1	059920-001
	2" deep filter		C-78-2	059920-002
	4" deep filter		C-78-4	059920-003
	1" deep filter as a prefilter to a Hi-Flo or Riga-Flo PH-A	U	C-78-2 ⁴	059920-002
	2" deep filter as a prefilter to a Hi-Flo or Riga-Flo PH-A		C-78-3 ⁴	059920-004
	4" deep filter as a prefilter to a Hi-Flo or Riga-Flo PH-A		C-78-5 ⁴	059920-006
	2" deep filter as a prefilter to a Opti-Pac		C-78-7	059920-008
RIGA-FLO [®] In Type 8 Holding Frame	To secure 12" deep filter — 24" x 24"	U or D	C-80 ⁵ or C-99	061180-000 114353-000
	To secure 12" deep filter — 24" x 12"		C-80 ² or C-99 ²	061180-000 114353-000
	To secure 6" deep filter — 24" x 24"		C-90	078948-000
	To secure 6" deep filter — 24" x 12"	U	C-90 ²	079445-000
	To secure 6" deep filter as a prefilter to a 12" deep filter—24" x 24"		C-91	
	To secure 6" deep filter as a prefilter to a 12" deep filter—24" x 12"	C-91 ²		
RIGA-FLO E-SERIES In Type 8 Holding Frame	To secure 12" deep filter — 24" x 24"	U or D	C-80 or C-99	061180-000 114353-000
	To secure 12" deep filter — 24" x 12"		C-80 ² or C-99 ²	061180-000 114353-000
RIGA-FLO In Competitive Holding Frame	To secure 12" deep filter — 24" x 24"	U or D	C-83	062529-000
	To secure 12" deep filter — 24" x 12"		C-83 ²	079618-000
	To secure 6" deep filter — 24" x 24"		C-83-6	
	To secure 6" deep filter — 24" x 12"		C-83-6 ²	
AEROPAC [®] ⁷ Durafil [®] ⁷ Riga-Flo PH Hi-Flo [®] In Type 8 Holding Frame	To secure 12" deep Aeropac (no header) — 24" x 24", 24" x 12"	U or D	C-80 ³ or C-99 ²	061180-000
	To secure a single header pocket style filter (Hi-Flo)	U or D	C-70	050025-000
	To secure a 12" deep single header style filter (Riga-Flo PH, Durafil, Aeropac)	U or D ⁵	C-70	050025-000
	To secure a 12" deep single header Aeropac style filter	D	C-100	114646-000
	To secure a 12" deep double header style filter	U	C-80 or C-100	061180-000
	To secure 6" deep single header style filter	U U or D	C-70 C-90	050025-000 078948-000
NOTES	¹ When using the Farr 30/30 Class 1 filter in this application, a C-77 fastener should be used.			
	² Two fasteners can be used for upstream application, however it is not recommended.			
	³ C-99 is also available in place of the C-80 to allow for more clearance downstream.			
	⁴ Hi-Flo filters can be accessed from either upstream or downstream.			
	⁵ To secure a Riga-Flo PH or Durafil using upstream access only, use a C-70 fastener, part number 050025-000. For the Durafil only, the C-70 fastener may be used on the downstream as well.			
	⁶ The terms upstream (U) and front access are synonymous, as are downstream (D) and rear access.			
	⁷ For upstream access & downstream access (Durafil and Aeropac only) where the filter goes through frame opening a C-70 fastener should be used. When the filter does not go through the frame opening then a C-80 or a C-100 (Aeropac only).			

Camfil Farr, Inc.

United States Tel: (973) 616-7300 Fax: (973) 616-7771
Canada Tel: (450) 629-3030 Fax: (450) 662-6035
E-mail: camfilfarr@camfilfarr.com

© Camfil Farr

<http://www.camfilfarr.info>
<http://www.camfilfarr.com>

Camfil Farr has a policy of uninterrupted research, development and product improvement. We reserve the right to change designs and specifications without notice.

